



**Electrolux**  
PROFESSIONAL

**Eco Preparation  
1400 mm Storage Cabinet with  
sliding doors h. 1600**

ITEM # \_\_\_\_\_

MODEL # \_\_\_\_\_

NAME # \_\_\_\_\_

SIS # \_\_\_\_\_

AIA # \_\_\_\_\_



132887 (SAS14N)

Storage Cabinet, h. 1600mm,  
with 3 shelves and 2 sliding  
doors, 1400mm

**Short Form Specification**

Item No. \_\_\_\_\_

Constructed in stainless steel. Intermediate shelves, supports and inner doors in stainless steel. Handles are formed by a fold in the sliding doors. Adjustable feet.

**Main Features**

- Handles in stainless steel for better hygiene and reliability.
- Sturdiness, stability and reliability of table accurately tested.

**Construction**

- Worktop with 50 mm high profile, in s/s Scotch Brite finishing, 15/10 in thickness with anti-drip edges and welded corners.
- Round section legs with feet in 304 AISI stainless steel, 50 mm in diameter, adjustable in height by +0/-40 mm.
- Base panel has 40mm high profile, is 8/10 in thickness with upturned edges and bar reinforcement. It is welded to legs for further structure reinforcement.
- Two double-walled sliding doors flush fitting to the front of the frame can be removed to facilitate cleaning of the cupboard interior.
- 304 AISI stainless steel feet, 150 mm high and 54 mm in diameter, adjustable by -35/+25 mm.
- Constructed entirely in stainless steel to offer maximum durability.
- Handles directly built into the sliding doors.

**Optional Accessories**

- Wheel kit for cupboards, 4 wheels (2 with brakes), D=1000 mm PNC 855299

APPROVAL: \_\_\_\_\_



Experience the Excellence  
[www.electroluxprofessional.com](http://www.electroluxprofessional.com)

Front

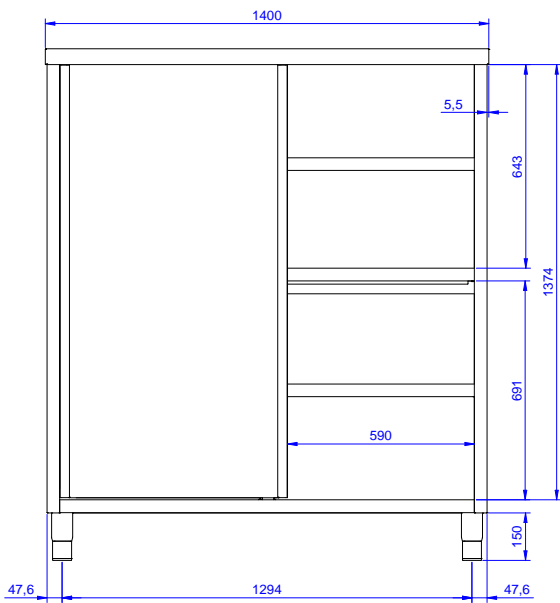

Side

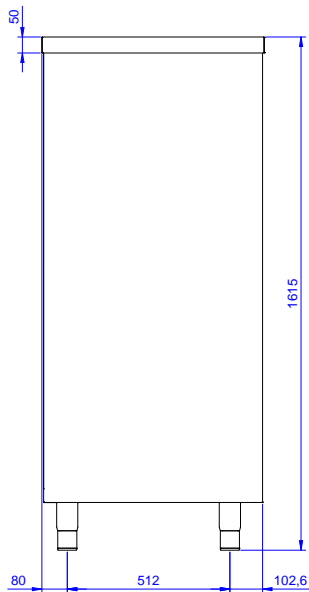

Top

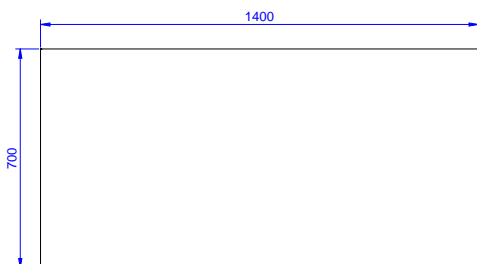

**Key Information:**

Cabinet width:	1345 mm
132887 (SAS14N)	
Cabinet depth:	645 mm
Cabinet height:	1365 mm
External dimensions, Width:	1400 mm
External dimensions, Depth:	700 mm
External dimensions, Height:	1600 mm
Net weight:	120 kg